

WINDOW TYPE	ELEVATION VIEW	PLAN OR SECTION VIEW
SINGLE OR DOUBLE SLIDER - FOR SLIDING WINDOWS THE CLEAR OPENING ONLY INCLUDES THE PORTION OF THE WINDOW THAT SLIDES. IT DOES NOT INCLUDE LIFTING A SASH AND REMOVING IT		PLAN
CASEMENT - THE HINGES ON A CASEMENT WINDOW MUST ALLOW THE SASH TO SWING OUT A MINIMUM 15". THIS MAY REQUIRE THE WINDOW TO HAVE SPECIAL EGRESS HINGES		PLAN
AWNING - CENTRE SUPPORT (IF APPLICABLE) CANNOT INTERFERE WITH MIN. REQUIRED CLEAR OPENING - CLEAR OPENING MUST BE MAINTAINED WITHOUT THE NEED FOR ADDITIONAL SUPPORT (SASH MUST BE SELF SUPPORTING IN OPEN POSITION)		SECTION
SINGLE OR DOUBLE HUNG - CLEAR OPENING MUST BE MAINTAINED WITHOUT THE NEED FOR ADDITIONAL SUPPORT (SASH MUST BE SELF SUPPORTING IN OPEN POSITION)		SECTION
TILT & TURN - MUST BE OPERABLE WITHOUT THE NEED FOR TOOLS OR SPECIALIZED KNOWLEDGE		PLAN

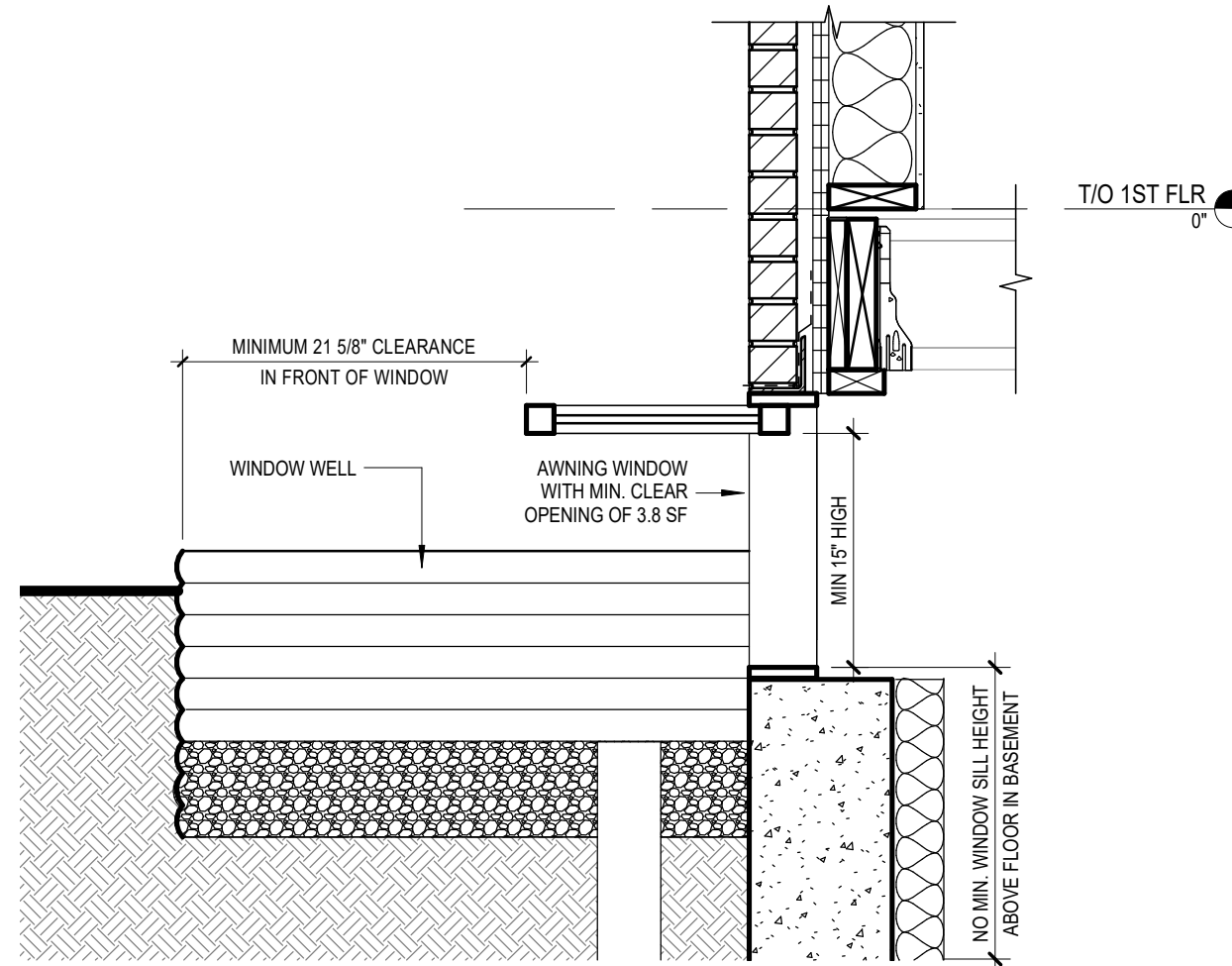

1 EGRESS WINDOW OPENING INTO WINDOW WELL
 0-6 1" = 1'-0"

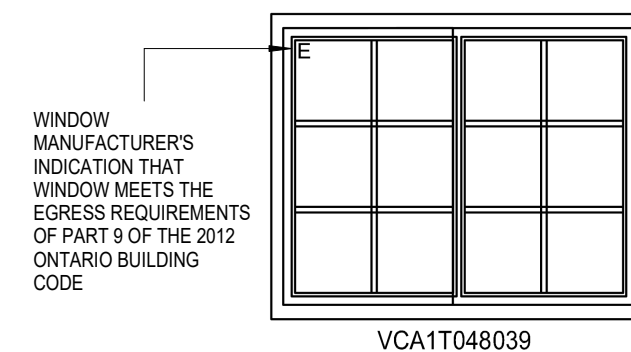

2 EGRESS WINDOW SPECIFICATION
 0-6 N.T.S.

NOTE

THE MINIMUM WIDTH AND HEIGHT OF THE EGRESS WINDOWS CLEAR OPENING AND MINIMUM CLEAR OPENING AREA OF THE EGRESS WINDOWS SHOWN ON THIS SHEET AND STATED ON MANUFACTURERS' SPECIFICATIONS MEET THE REQUIREMENTS OF PART 9 OF THE 2012 ONTARIO BUILDING CODE. THERE ARE ALSO EGRESS WINDOW REQUIREMENTS UNDER PART 11 OF THE 2012 ONTARIO BUILDING CODE. UNDER PART 11 SOME EGRESS WINDOWS REQUIRE A MINIMUM WIDTH AND HEIGHT OF THE EGRESS WINDOW CLEAR OPENING IS 18 1/2" AND THE MINIMUM CLEAR OPENING AREA IS 4.1 SF.

SAMPLE DRAWINGS



TOWN OF MILTON
 BUILDING DIVISION

150 MARY ST
 MILTON ON L9T 6Z5
 (905) 878-7253 EXT. 2397

BUILDING PERMIT APPLICATION GUIDE:
EXTERIOR OPENINGS

DRAWING NAME:
SUMMARY OF EGRESS WINDOW REQUIREMENTS

NUMBER OF COPIES REQUIRED:
 N/A

DRAWING **MUST** INCLUDE/SHOW (IF APPLICABLE):
 N/A - FOR REFERENCE ONLY

DESIGNER: JOE SMITH

PROJECT 123 MAIN STREET
 ADDRESS: MILTON, ONTARIO

SHEET SIZE: 11" X 17"

DATE: JANUARY 2016

SCALE: AS INDICATED

SHEET NO.

0-6